

TR Multi Fuel Stoves

Heat your home for
less with our quality
Irish engineered
stoves



The best of Irish engineering



Inspiration

Heat Design TR stoves have been heating homes for the last 15 years and continue to provide unrivalled heating technology quality. Years of development work in our stove research laboratory in Dublin has improved our products beyond recognition and represents a huge leap forward in stove combustion technology. Heat Design's TR appliances are the result of concentrated research which has resulted in our cleanest burning, most efficient stoves yet. Continuous product improvement means that our stoves burn less fuel for longer, saving you money.

Creation

The result of our research in Dublin has delivered a finely tuned heating appliance manufactured in our ISO 9001 facility. TR stoves are assembled using materials such as high grade cast iron, heavy duty steel, stainless steel, ceramic glass and world class heat resistant coatings which offer unrivalled performance when assembled to our exacting standards.

Our stoves are designed and built to comply with CE standards EN 13240 & EN 13229.

TR Multi Fuel Stove Range

THE FEATURES

- Saves you money – uses only 25% of the amount of fuel used in an open fire
- CE approved up to 78.8% efficient
- Refuel less often
- Less ash means less cleaning
- Exceptionally clean airwash system
- Cleanburn technology with Tertiary Air
- The TR air distribution system ensures that fuel is burnt evenly and efficiently
- Fully constructed in high grade cast iron and heavy duty steel for long life
- Top or rear outlet flue
- Adjustable leg height



TR3

Multi Fuel Stove

Perfect for smaller rooms, the TR3 is the smallest stove in the TR cast iron stove range and the heat from this compact stove will surprise you. The TR3 will warm up the coldest winter nights without compromising on any of the features you would expect.

Stove Height: 505mm



Fits perfectly into your home



TR5

Multi Fuel Stove

The crisp lines of this classic stove with highly efficient output combines beauty and practicality in any fireplace or room setting. The TR patented Scirrocco air management system allows you to select the appropriate heat output whilst getting the maximum benefit from every load of fuel and maximising efficiency.

Stove Height: 600mm



Heat your room in style



TR Midi 6.5kw and TR8 also available

TR5c

The extra large glass door gives you an unimpaired view of the wonderful, dancing flames.

The beauty of these stoves is coupled with a multi-fuel grate, incredible heat output and efficiency.

Stove Height: 595mm



Our unique stoves add warmth to your home



TR8c

Stove Height: 595mm

TR25

Multi Fuel Stove

This stove is a powerhouse, capable of heating the largest homes with its 16-18 radiator capacity. This hard working stove maintains its good looks and delivers all the features you would expect.

Stove Height: 820mm



 This stove heats **16/17 radiators*** including domestic hot water.

Heat the whole house



TR14 also available
(6-8 radiators including hot water)

* Based on standard single radiators and depends on proximity to appliance

TR4 Insert Stove

Easy Installation using our Unique
Patented Fixing Mechanism.

The TR4 Insert Stove can be simply
installed by any D.I.Y. enthusiast.

Stove Height: 595mm



Transform your fireplace

Install a
TR Stove
& improve your
BER rating
by
over 10%



Step 1.

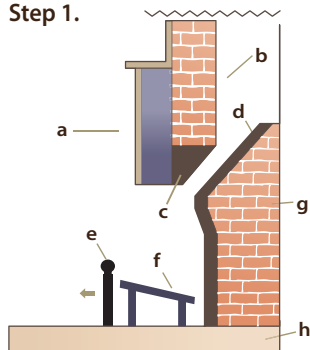

a. Fireplace Back Panel
f. Grate

Step 2.



b. Chimney Breast
g. Back Wall

Step 3.

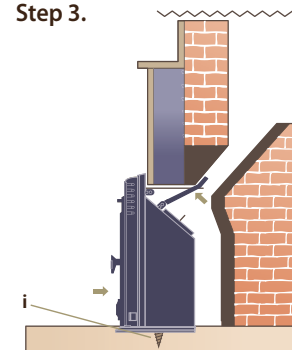

c. Lintel
d. Fireback
e. Fret
i. Securing Screw



The TR stove range features the Heat Design patented Scirrocco Air Management System. This innovative system allows total control of the air supply resulting in perfect burning conditions while also delivering clean glass which allows an uninterrupted view of the fire.

Its simple! Here's how it works:

Firstly, you control the delivery of air into the bottom of the stove which allows easy control of the flame and rate at which the fire burns. You can also control the amount of air allowed into the stove through the Scirrocco Air Management system at the top of the stove which flows down the front of the glass, keeping it clean and allowing the flame to always be on view. The air then rises back into the combustion box which allows for longer burning time of fuel.

Finally, it allows control of preheated air which is introduced through the system at the top of the stove. This air passes through a heat exchange chamber into the combustion box where it creates a longer and more economical burn.

The Scirrocco Air Management System provides you with the ability to control all air flows which allows for a cleaner, more efficient stove and complete control of the flame. From a deep glow to whirling flames in seconds- all from air delivered through this efficient system.



DIMENSIONS

TR3 Multi Fuel Stove (featured page 4)



Weight: 65Kg



Non Boiler Stove
Heat Output: 3 - 4KW / 12,250BTU's



Fuel: Solid fuel or wood
(wood moisture content should be below 20% for optimum burning)

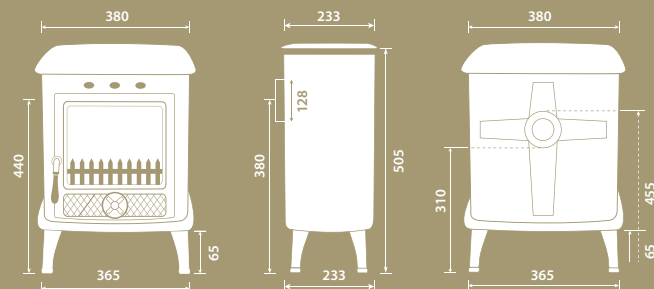

TR5 Multi Fuel Stove (featured page 5)



Weight: 85Kg



Non Boiler Stove
Heat Output: 5KW / 17,500BTU's



Fuel: Solid fuel or wood
(wood moisture content should be below 20% for optimum burning)

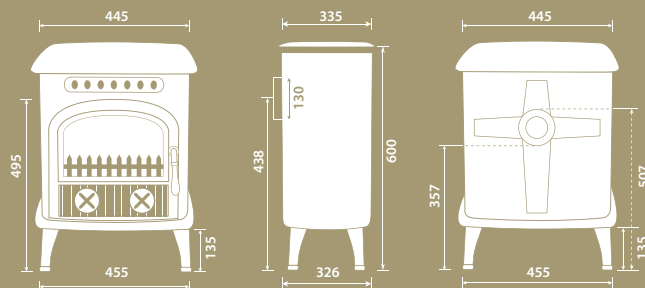

TR MIDI Multi Fuel Stove



Weight: 118Kg



Non Boiler Stove
Heat Output: 6.5KW / 22,750BTU's



Fuel: Solid fuel or wood
(wood moisture content should be below 20% for optimum burning)

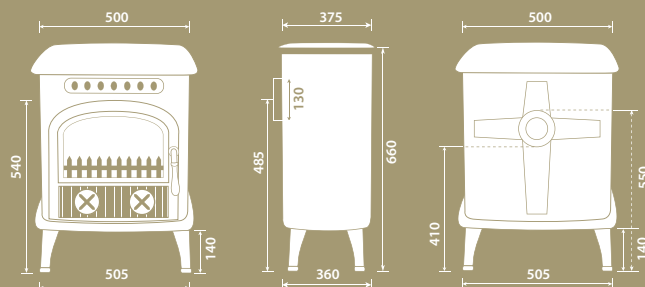

TR8 Multi Fuel Stove



Weight: 143Kg



Non Boiler Stove Output: 8KW / 28,000BTU's
Boiler Stove Output: 5.2KW / 18,200BTU's

3 - 4 Radiators*
including Domestic Hot Water

Room Heat: 2.8KW / 9,800BTU's



Fuel: Solid fuel or wood
(wood moisture content should be below 20% for optimum burning)

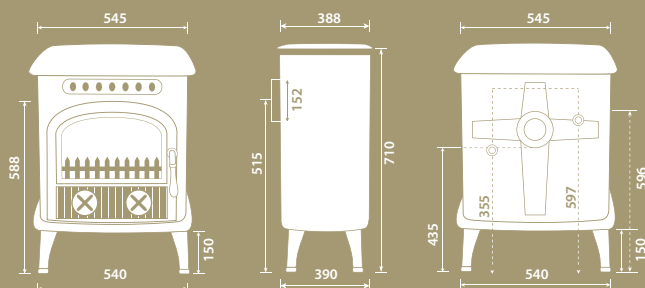

TR5c Multi Fuel Stove (featured page 6)



Weight: 64.5Kg



Non Boiler Stove
Heat Output: 5KW / 17,500BTU's



Fuel: Solid fuel or wood
(wood moisture content should be below 20% for optimum burning)

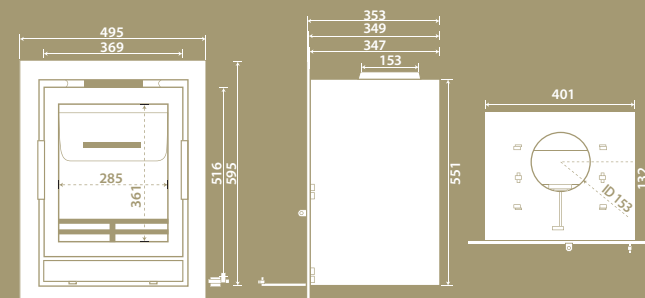

TR8c Multi Fuel Stove (featured page 6)



Weight: 90Kg



Non Boiler Stove

Heat Output: 8KW / 28,000BTU's



Fuel: Solid fuel or wood
(wood moisture content should be below 20% for optimum burning)

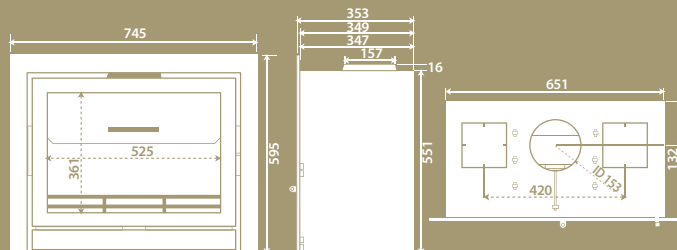

TR14 Multi Fuel Stove



Weight: 200Kg



Non Boiler Stove Output: 14KW / 49,000BTU's

Boiler Stove Output: 9.1KW / 31,850BTU'sBTU's

6 - 8 Radiators*
including Domestic Hot Water

Room Heat: 4.9KW / 17,150BTU's



Fuel: Solid fuel or wood
(wood moisture content should be below 20% for optimum burning)

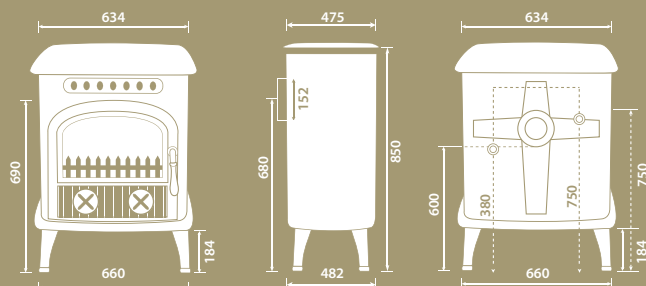

TR25 Multi Fuel Stove (featured page 7)



Weight: 226Kg



Boiler Stove Output:

Boiler: 16.25KW / 56,875BTU's

16 - 17 Radiators*
including Domestic Hot Water

Room Heat: 8.75KW / 30,625BTU's



Fuel: Solid fuel or wood
(wood moisture content should be below 20% for optimum burning)

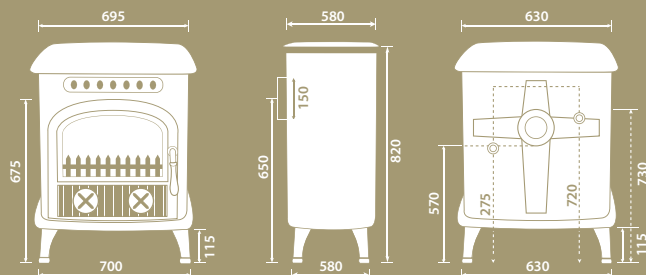

TR4 Insert Stove (featured page 8)



Weight: 80Kg



Non Boiler Stove

Heat Output: 4KW / 14,000BTU's



Fuel: Solid fuel or wood
(wood moisture content should be below 20% for optimum burning)

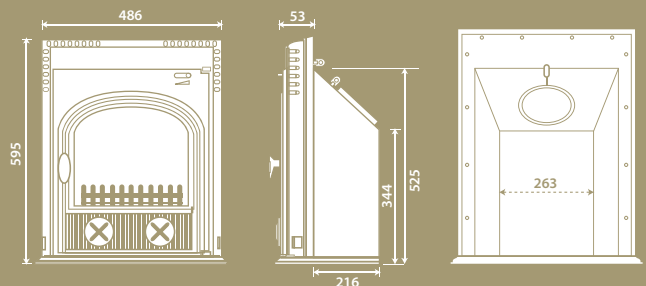

* Based on standard single radiators and depends on proximity to appliance.
The TR Range of multi fuel stoves are ideal for burning wood, coal or peat. (The use of petrochemicals is not recommended).



Head Office

60 Hawthorn Road,
Western Industrial Estate,
Naas Road, Dublin 12.

Telephone: **00 353 (0)1 408 9192**
Email: **info@heatdesign.ie**

www.heatdesign.ie